

1547 Sq. Ft.

28' x 56'

2 Bed/2 Bath

Summer Retreat

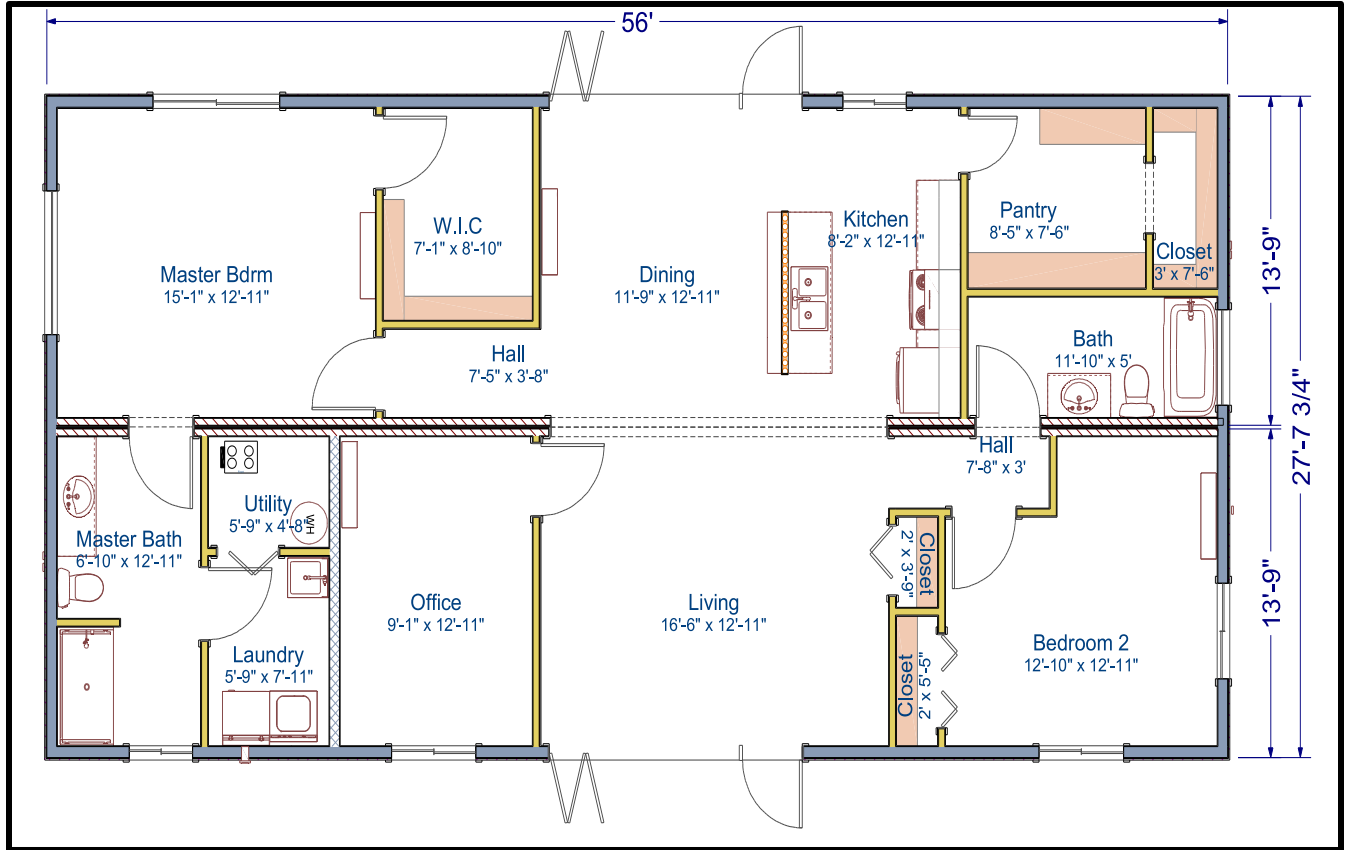

The Summer Retreat modular home boasts an open-concept design with a spacious living area. Homeowners can install large accordion doors to enhance the space. With 1,547 square feet of living area, this home is perfect for a Summer Retreat or income property.

For more information, contact our Sales Office.



Not in Contract: land, site preparation, foundation, garages, decks, stairs, railings, appliances, insulation under main floor, waste plumbing under main floor, HVAC, Flooring, and Accordion Doors. **Floor plans and/or elevations may show optional features.**

TLC Modular Homes

www.tlcmodularhomes.com • 509-773-5055 •

1600 S. Roosevelt • Goldendale, WA 98620 •

Washington: WESTCC*01218 Electric WESTCAC002R0; Oregon: 149296