

1,748 Sq. Ft.
29'x60' Ranch
2 Bed / 2 Bath

Deschutes Floor Plan

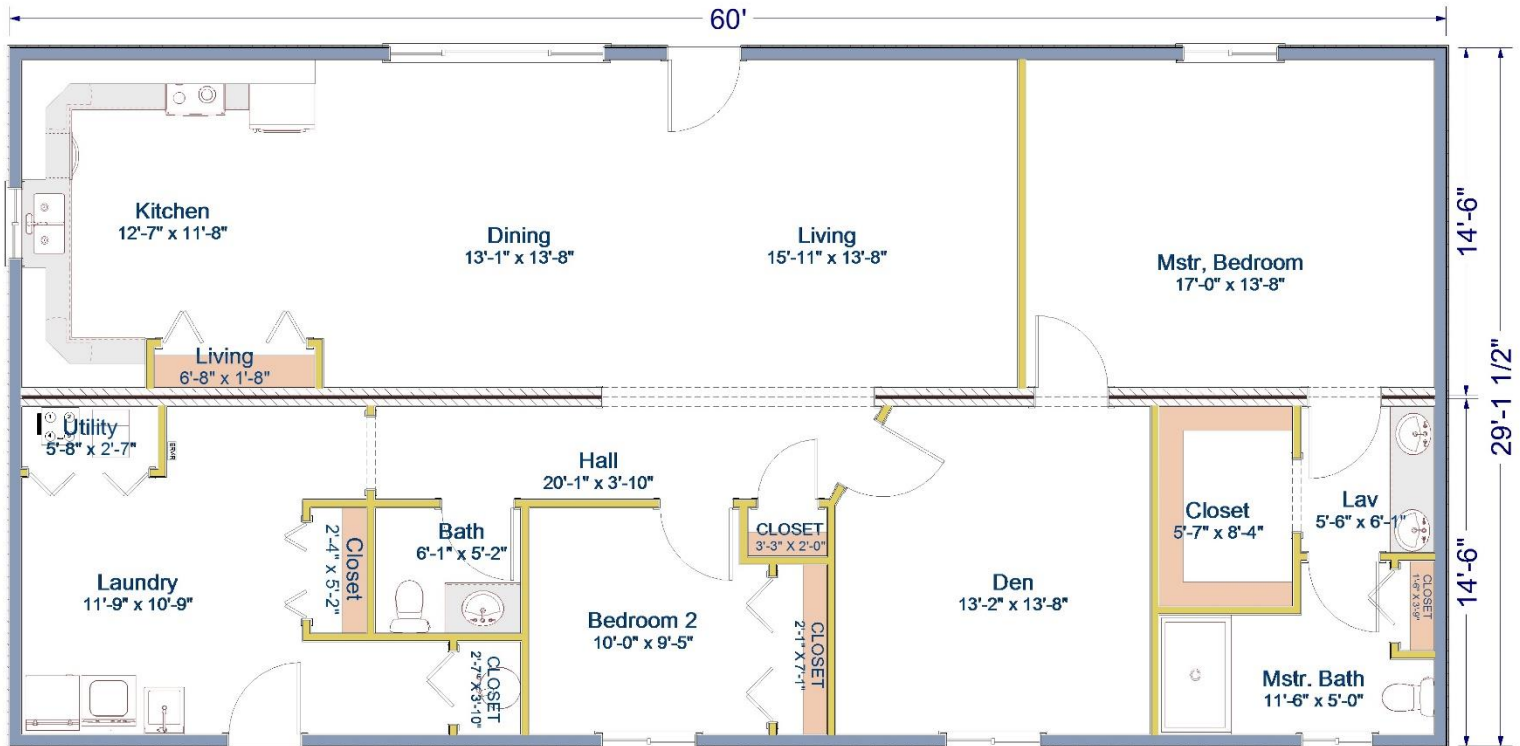

The Deschutes modular home is an open concept plan that boasts a large living area. The large den is a great asset for those who work from home. This 1,748 square foot home is the perfect home for the hard-working family.

Contact our Sales Office for more information



Not in Contract: land, site preparation, foundation, garages, decks, stairs, railings, appliances, insulation under main floor, waste plumbing under main floor. *Floor plans and/or elevations may show optional features.*

TLC Modular Homes

www.tlcmodularhomes.com • 509-773-5055 •

1600 S. Roosevelt • Goldendale, WA 98620 •

Washington: WESTCC*01218 Electric WESTCAC002R0; Oregon: 149296