

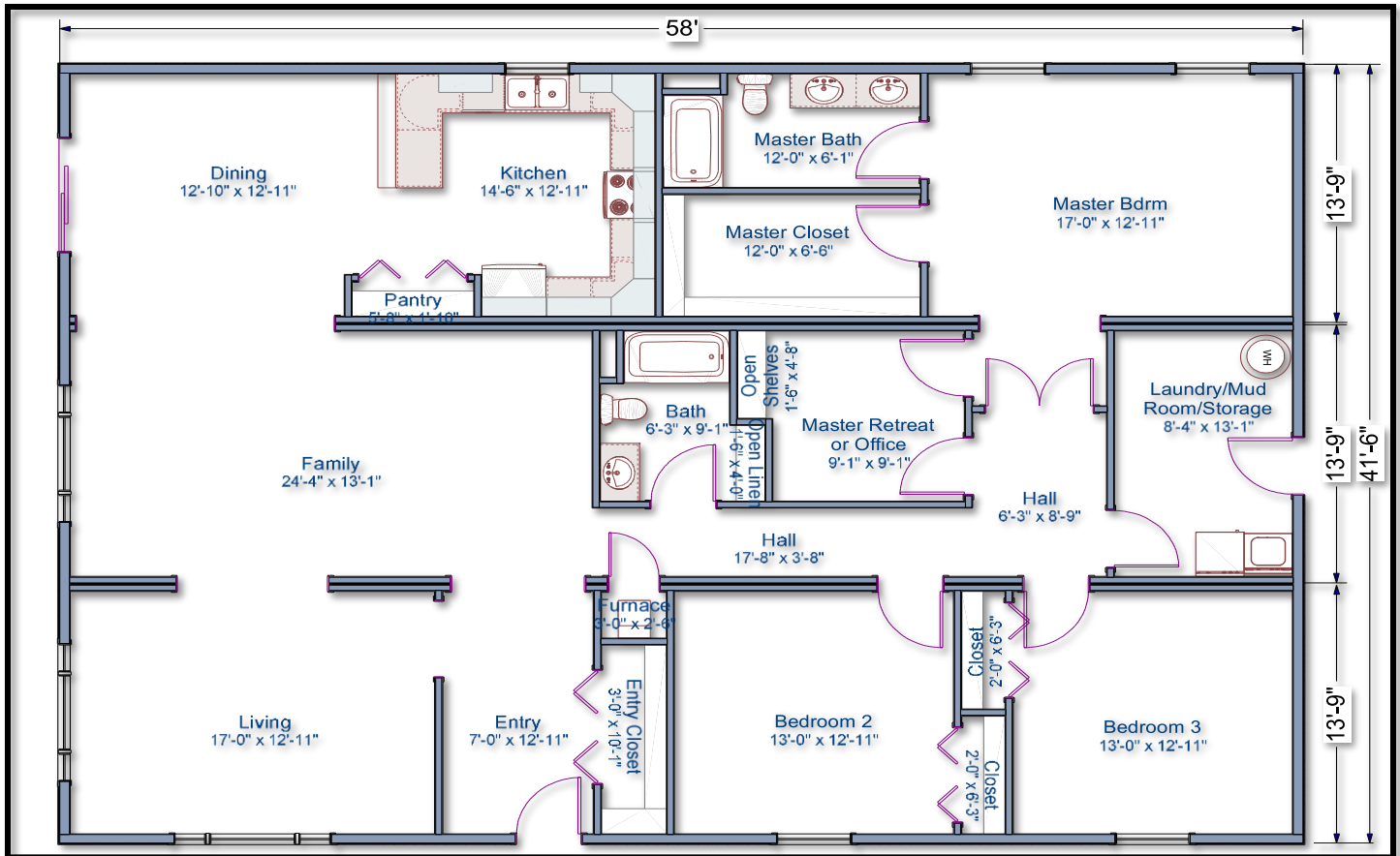

"Cascade"

**2,407 Sq. Ft. /
41'x58' Ranch / 3
Bedroom / 2 Bath**



The Cascade is an open concept plan that boasts a large family area and a private living room for guests. The large master suite with walk in closet is convenient to the laundry room along with the other 2 bedrooms in this functional home. This 2,407 square foot home is the perfect home for a growing family.



Not in Contract: land, site preparation, foundation, garages, decks, stairs, railings, appliances, insulation under main floor, waste plumbing under main floor. **Floor plans and/or elevations may show optional features.**

Contact our Sales Office for more information.

TLC Modular Homes

www.tlcmodularhomes.com • 509-773-5055 •

1600 S. Roosevelt • Goldendale, WA 98620 •

Washington: WESTCC*01218 Electric WESTCAC002R0; Oregon: 149296