

1,748 sq. ft.
29'x60' Ranch
3 Bed/2 Bath

River House Floor Plan

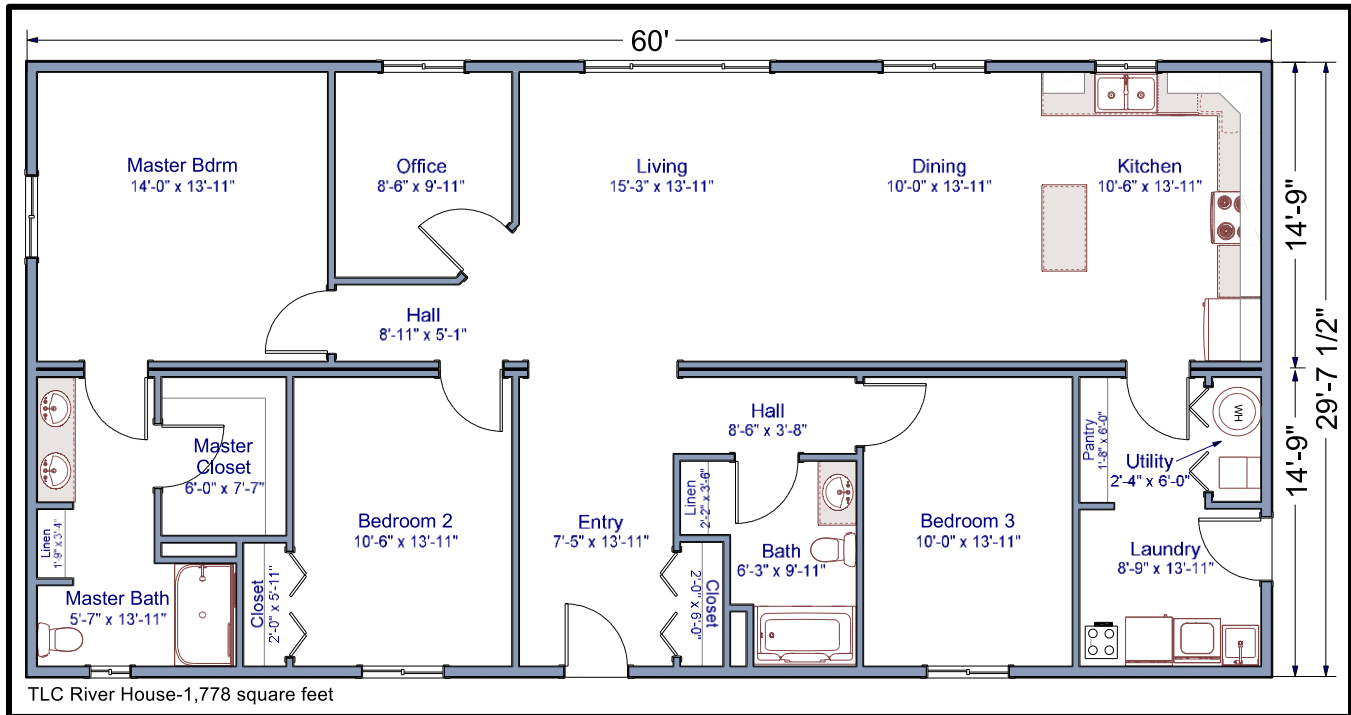

The 1,748 modular home is an open concept plan that boasts a large living area. A separate office is a nice feature for those that work from home. This 1,748 square foot home is the perfect home for the busy family.

Contact our Sales Office for more information



Not in Contract: land, site preparation, foundation, garages, decks, stairs, railings, appliances, insulation under main floor, waste plumbing under main floor. *Floor plans and/or elevations may show optional features.*

TLC Modular Homes

www.tlcmodularhomes.com • 509-773-5055 •

1600 S. Roosevelt • Goldendale, WA 98620 •

Washington: WESTCC*01218 Electric WESTCAC002R0; Oregon: 149296